

PROPOSED B+G+XI (36.9 M. HT.) STORIED RESIDENTIAL BUILDING AT 24 BASANTALAL SAHA ROAD, KOLKATA-700053, WARD NO - 117, BOROUGH NO - XIII,

AREA OF LAND (AS PER DEED)
 =6B 15K 7CH 27SQ.FT. = 9061.71 SQM.
 AREA OF LAND (AS PER DEED)
 =6B 15K 7CH 27SQ.FT. = 9061.71 SQM.
 SCALE=1:800

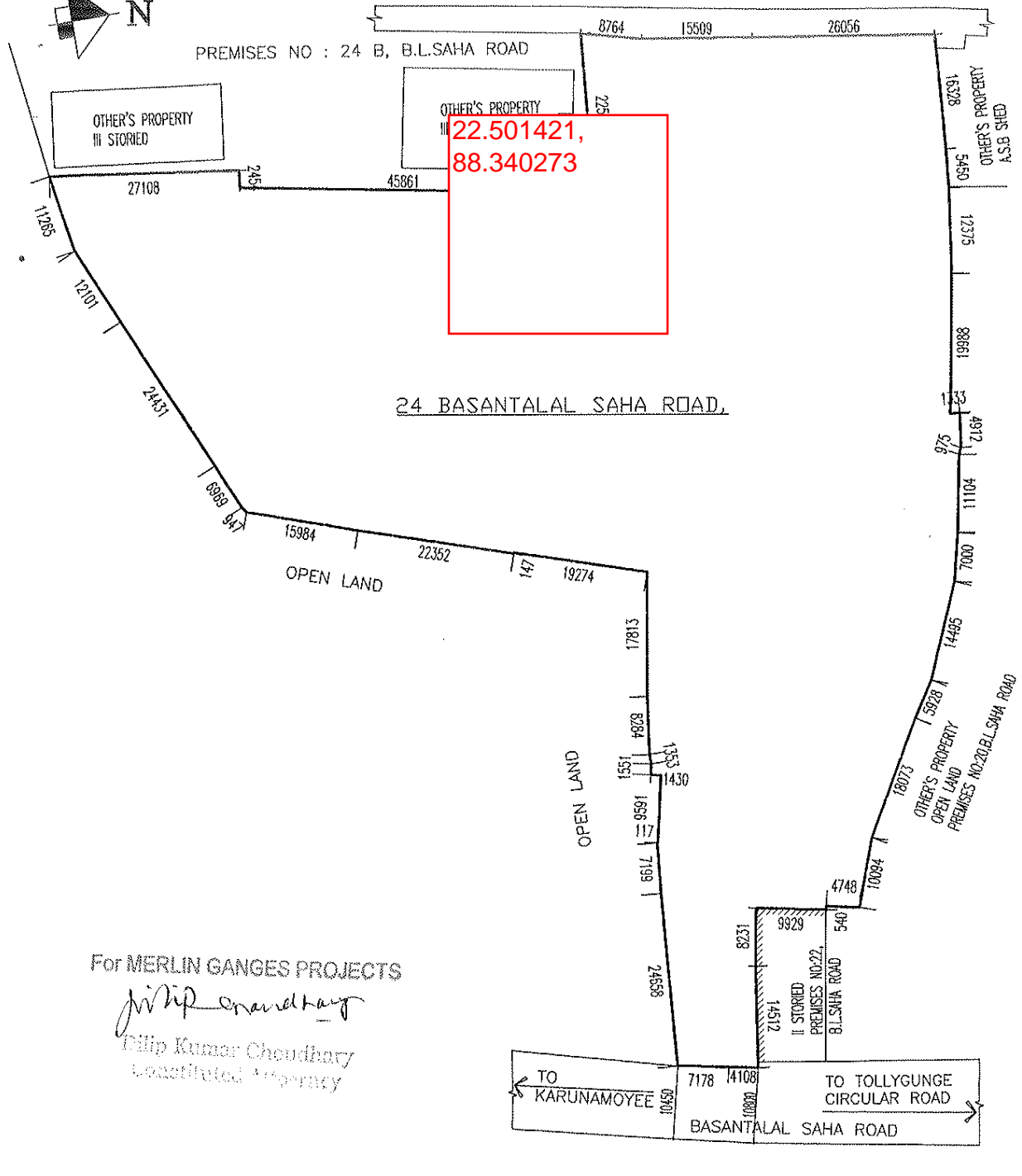

Latitude & Longitude 22.501421, 88.340273